



MOVE INN ESTATES

MAKING THE RIGHT MOVE



Rose Park Close

, Hayes, UB4 9AT

Price Guide £600,000



Floor Plan

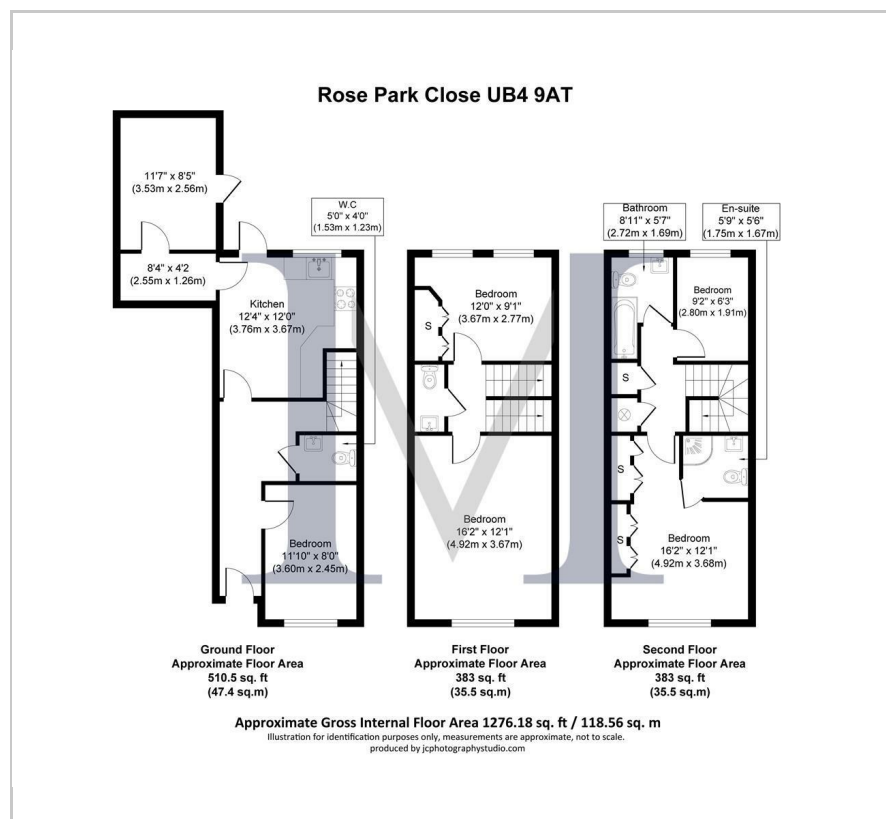

Area Map

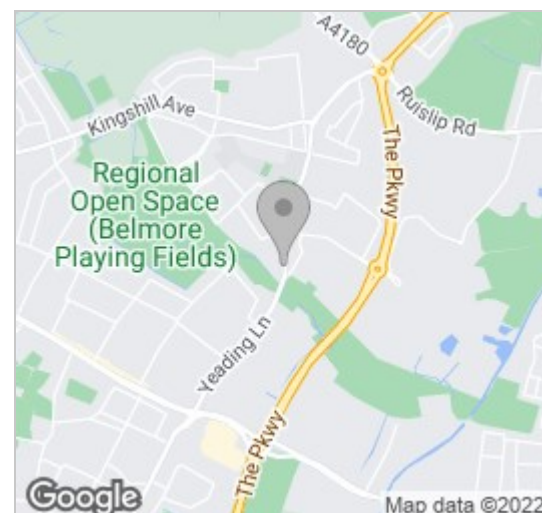

Energy Efficiency Graph

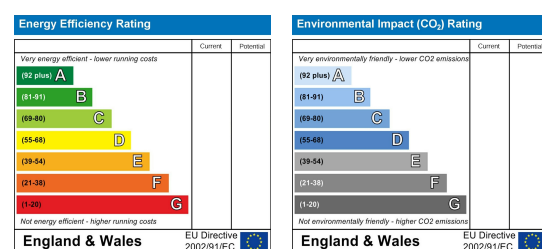

Viewing

Please contact our Move Inn Estates - Sales Office on 0208 574 4966 if you wish to arrange a viewing appointment for this property or require further information.

- four bedrooms
- Close to Transport links
- Close to Schools
- En - Suite to Master Bedroom
- 16ft Living Room
- 12ft Kitchen / Dining Room
- Family Bathroom
- Large Rear Garden
- Off Road Parking

**** POPULAR LOCATION**** This **FOUR** bedroom family **TOWNHOUSE** located in a cul de sac location, offered in good condition throughout. The property is situated in a sought after area of North Hayes which includes easy access to motorway links such as the A40 and M40.

The property is located only a short distance from local sought after schools and a few minutes drive from Hayes Town with its array of shops and eateries. The property boasts a 16ft living room, 12 ft kitchen / dining room, bedroom and cloakroom on the first floor and the top floor hosts two bedrooms with the master bedroom having an en-suite and family bathroom. The property has a spacious rear garden and ample parking to the front of the property with a garage to the side.

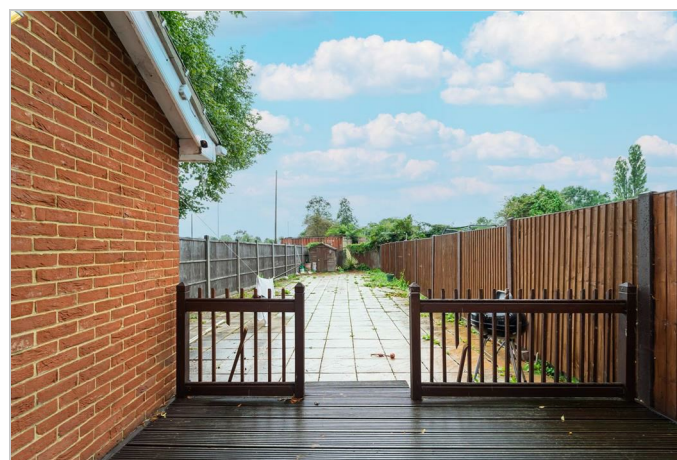

These particulars, whilst believed to be accurate are set out as a general outline only for guidance and do not constitute any part of an offer or contract. Intending purchasers should not rely on them as statements of representation of fact, but must satisfy themselves by inspection or otherwise as to their accuracy. No person in this firm's employment has the authority to make or give any representation or warranty in respect of the property.

46 Vicarage Farm Road, Hounslow, Middlesex, TW5 0AB

Tel: 0208 574 4966 Email: info@moveinnestates.co.uk www.moveinnestates.co.uk